



P&PE

PUMPS & PROCESS EQUIPMENT INC.

To Request a Quote,

CALL US 1-847-882-8116



Roper Pumps

ROC[®]
Series

The ROC goes with the flow and performs spotlessly in stainless steel

ROC Solid Service



The leading force behind liquids.

Applications

- Chemical processing
- Pharmaceutical industries
- Injection and transfer applications of acids and solvents
- Trademarked design

Features

- Heavy duty stainless steel gear pumps for optimum chemical capability
- Back pull-out design for easy maintenance without disturbing piping
- One-piece "D" style bushings eliminate the need for wearplates and provide positive alignment and gear support
- Capable of operating at nominal motor speeds

- Good for up to 300 psi differential pressures
- No integral relief valve available, external relief recommended

Options

- Various drive arrangements
- Close-coupled bracket and magnetic drive arrangements available for the small series

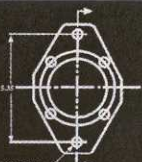
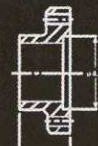
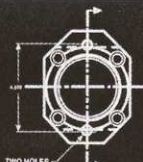

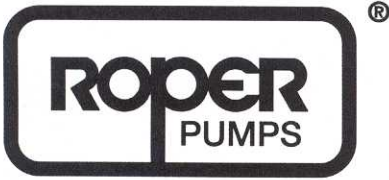

Roper Pump Company
 P.O. Box 269 • Commerce, GA 30529
 Toll Free: 1-800-876-9160 • Fax: 706-335-5490
 sales@roperpumps.com

Visit Us On The WorldWide Web
www.roperpumps.com

ROC® Series

| Model | Theoretical Capacity | Maximum Speed | Maximum Flow at Maximum Speed (0 Discharge Pressure) | Maximum Pressure | Port Connection |
|-------|------------------------|---------------|--|------------------|-----------------|
| X2.5 | .00025GPR(.946 CC/REV) | 3600 RPM | 0.9GPM (.204 M ³ /HR) | 300 PSI (20 Bar) | 1/2"NPT" |
| X5 | .0005GPR(1.89 CC/REV) | 3600 RPM | 1.8GPM (.41 M ³ /HR) | 300 PSI (20 Bar) | 1/2"NPT" |
| 01 | .001GPR(3.79 CC/REV) | 3600 RPM | 3.6GPM (.82 M ³ /HR) | 300 PSI (20 Bar) | 1/2"NPT" |
| 02 | .002GPR(7.57 CC/REV) | 3600 RPM | 7.2GPM (1.64 M ³ /HR) | 300 PSI (20 Bar) | 1/2"NPT" |
| 03 | .003GPR(11.36 CC/REV) | 3600 RPM | 10.8GPM (2.45 M ³ /HR) | 300 PSI (20 Bar) | 3/4"NPT" |
| 07 | .007GPR(26.5 CC/REV) | 1800 RPM | 12.6GPM (2.86 M ³ /HR) | 300 PSI (20 Bar) | 1-1/2"NPT" |
| 12 | .012GPR(45.42 CC/REV) | 1800 RPM | 21.6GPM (4.91 M ³ /HR) | 300 PSI (20 Bar) | 1-1/2"NPT" |
| 18 | .018GPR(68.14 CC/REV) | 1800 RPM | 32.4GPM (7.36 M ³ /HR) | 300 PSI (20 Bar) | 2"NPT" |

Materials of Construction

| Housing | Gears/Shafts | Bearings | O'Rings |
|-----------------------|-----------------------------------|----------------------|---------|
| • 3166SS ASTM A743 | • 17-4pH SS ASTM A564 Type 630 | • Carbon Graphite | • PTFE |
| Options | | • Silicon Carbide | |

Key Features

- Helical gears for quiet operation
- Bi-directional rotation
- Seal flexibility - single or double in large sizes
- Two moving parts for less wear and reduced maintenance
- Close coupled or foot mount design

